

WINE MASTER

le temps d'être différent

DESIGN, SILENCE AND DISCREET

WineMaster® offers a discreet air conditioner version with a different design and ever increasing performance. Wine OUT25X is installed outside your cellar, it allows you to air condition up to 25m³ and benefits from many advantages such as silence and energy savings.

WINE CELLAR AIR CONDITIONER



WINE OUT25X

THE BUILT IN

25 m³

Air-conditioning up to 25m³



High performance integrated thermostat



Quiet



Respectful of the environment



Ideal climate conditions for the preservation of your wine



NEW
Connectable device (function with subscription)



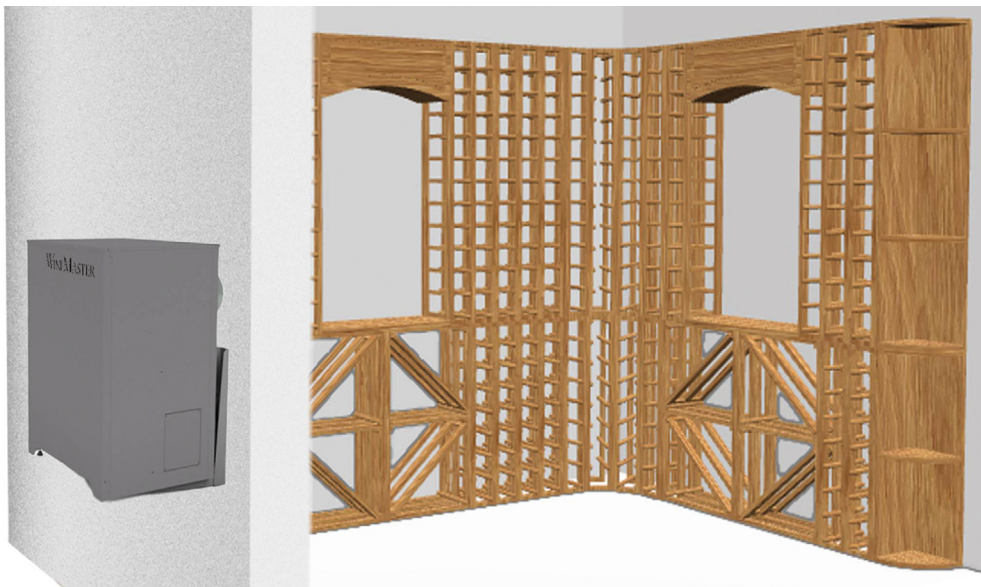

WINE OUT25X

SILENCE, PERFORMANCE AND SAVINGS

- Keeps cellars at a constant temperature of between 8 and 18 °C*
- Humidity control : excess humidity is condensed and evacuated towards the outside
- The dimensions of the appliance allow it to be adapted to different rooms (cellar, attic, etc.)
- Controlled power consumption thanks to the reaction turbine on the condenser side
- Cooling and heating
- The Wine OUT25X model is equipped with a heating belt for protection in case of conditions (e.g. in winter).
- Thermostatic expansion valve, best suited to difficult conditions
- Remote thermostat
- Easy maintenance with cleanable filter
- 2 year warranty

DELIVERED WITH :

- X 2 straight ducts with \varnothing 125 mm - length 500 mm each

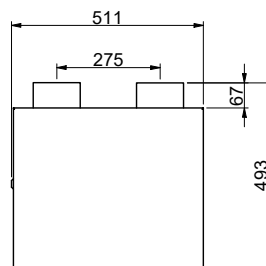
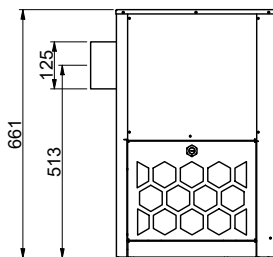
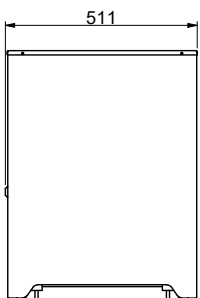



ALWAYS
MORE SILENCE
 ALWAYS
MORE DISCREET

In addition to its innovative design, the WineMaster OUT25X, because of its external installation, is very discreet. Only the ventilation grids are visible in your cellar.

THE STRENGTHS OF THE WINE OUT25 AIR CONDITIONER

- 2 rotation speeds for the fan motor on the cellar side
- Silent operation thanks to the use of new materials
- Suitable for small cellars (e.g. under stairs)
- Saves space in the cellar

THE BUILT IN **WINEMASTER®**

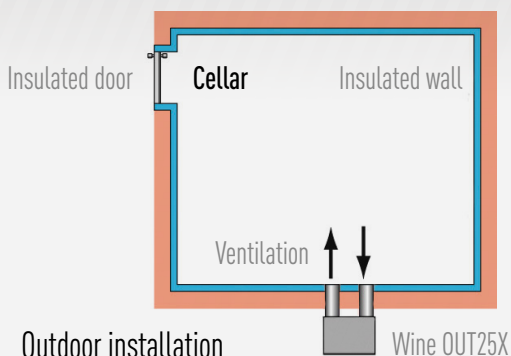

REFERENCE	WINE OUT25X
Electrical supply	235 V - 50Hz + 3 m cable
Air conditioning capacity*	Up to 25 m ³ *
Overall dimensions	W. 511 x H. 661 x D. 493 mm
Weight	53 Kg
Cooling capacity**	550 W at 15°C
Electrical power absorbed	400 W
Sound level in the cellar (outside the cellar)	48 dB at 1 m / 40 dB at 3 m
Cellar airflow rate (cold side)	150 at 200 m ³ /h
Outside airflow rate (hot side)	150 at 200 m ³ /h
Coolant	R290
Heat resistance	250 W
Temperature setting*	Preset at 12°C, adjustable between 8 and 18°C *
Maximum outside temperature**	40°C
Heating belt	Yes

* With right insulation and adapted to the volume of the cellar.

** The power could be reduced in function of outside temperature, its why the device may lose capacity to keep the cellar at 12 °C if the outside temperature gets close to 40 °C..

WINEMASTER CONNECT,
 Just one box and your wine cellar is connected!



Optimal wine conservation



Remote supervision

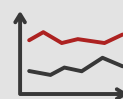

Statistics in real time



Failure alerts

Thanks to WineMaster Connect, you can remotely adjust and ensure the correct operation of your air conditioner. Simply plug our connected box into your air conditioner to monitor or change the main operating parameters in real time.

This device works with a subscription. Ask your retailer for details of pricing.



A STORY OF LOVE AND TERROIR...

It is in the foothills of the Alsatian vineyards, where the wine route starts, that the WineMaster® story begins. Our attachment to terroir and our love of wine have always been the source of our thought process and creativity.

Ever since its inception in 1984, the skills and know-how of the men and women of WineMaster® have been at the heart of every step in the air conditioner making process.

Quality and detail are what motivate us, and we are proud of our products and their 100 % Alsatian design.

“ INNOVATION AND EXCELLENCE ARE
WINEMASTER'S KEY VALUES. ”

